



Top push rod -
metal and high
rod plunger
KSA2

Product designation

Product type designation

General characteristics

Material

Housing

Polymer
thermoplastic

Contact characteristics

Type of contact		1NO/NC
Thermal current Ith	A	15
IEC/EN 60947-5-1 designation		A600 P300
Rated insulation voltage Ui	V	250
Switching speed		

min	m/s	0.01
max	m/s	1

Operating speed

min	m/s	0.05
max	m/s	1

IEC Conventional free air thermal current Ith	A	15
Resistance per pole (average value)	mΩ	<15
Conductivity		10mA 5V

Mechanical features

Terminals type		Screw
Operating head fixing		Fixed
Operating torque		

N	2.5
ozin	9

Weight	g	33
--------	---	----

Operations

Mechanical life	cycles	20000000
Electrical life	cycles	500000
Mechanical operation	cycles/h	240

Ambient conditions

Temperature

Operating temperature

min	°C	-25
max	°C	+70

Storage temperature

min	°C	-40
max	°C	+70

Resistance & Protection

IP degree

Body housing

IP00 or IP20 with
terminal shroud

Pollution degree

3

Dimensions

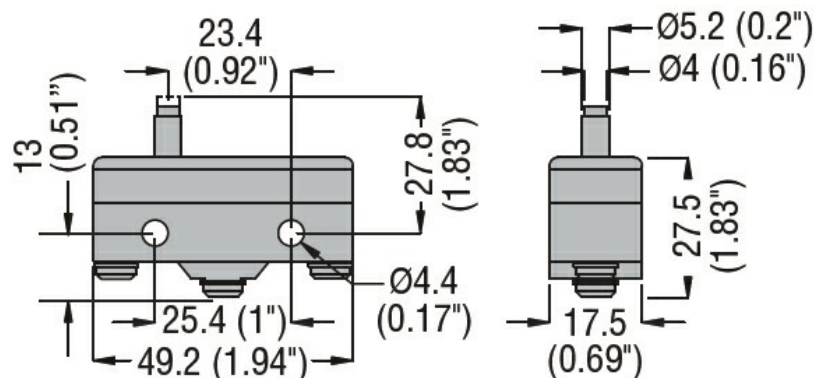

Wiring diagrams

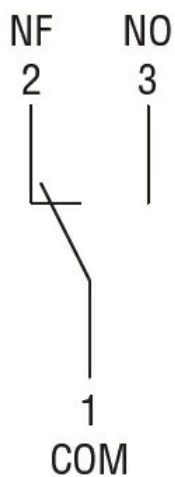

Certifications and compliance

Compliance

CSA C22.2 n° 14.

IEC/EN 60947-1

IEC/EN 60947-5-1

IEC/EN 61058-1

UL508

Certificates

cURus

EAC

ETIM classification

ETIM 8.0

EC000030 - End switch