



Product designation
Product type designation

Palm switches
LP9

General characteristics

Colour	Grey/Yellow with red mushroom	
Type of positions	Pull to release	
Resistance value	KΩ	≤0.025
Material	PC-ABS for button and control station. Chrome-plated zamak for metal operator frame	
IEC degree of protection	IP65	

Electrical characteristics

Rated insulation voltage Ui IEC/EN	V	690
IEC Conventional free air thermal current Ith	A	10
Rated frequency	Hz	50
Conductivity	5V 10mA	
UL/CSA and IEC/EN 60947-5-1 designation	A600 Q300	
Operating current AC15	12V	A 6
	24V	A 6
	48V	A 6
	120V	A 6
	240V	A 3
	400V	A 1.9
	480V	A 1.5
	500V	A 1.4
	600V	A 1.2
Operating current DC13	12V	A 3
	24V	A 3
	48V	A 1.5
	125V	A 0.55
	250V	A 0.27
	440V	A 0.15
	500V	A 0.13
	600V	A 0.1

Mechanical features

Operating force	kg-lb	≤2.6Nm
Mechanical life	cycles	1000000
Tightening torque for terminals max	Nm	0.5 ... 0.8 Nm
Conductor section	IEC	
	min	mm² 0.5

		max	mm²	2.5
Operating position				
		allowable	Any	
Ambient conditions				
Temperature				
Operating temperature				
		min	°C	-25
		max	°C	+75
Storage temperature				
		min	°C	-40
		max	°C	+85

Dimensions

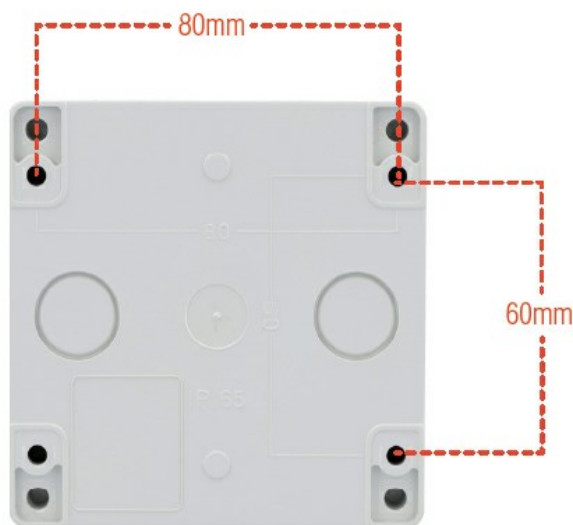
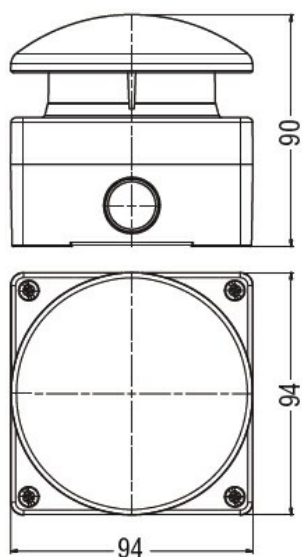

Wiring diagrams

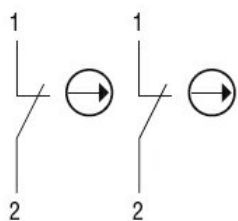

Certifications and compliance

Compliance

IEC60947-5-1

Certificates

/

ETIM classification

ETIM 8.0

EC002034 -
Emergency stop
complete