



Signal tower  
Ø50mm/1.97"  
LTN50

Product designation

Product type designation

### General characteristics

Diameter	mm - inch	50 / 1.97
Material		Metal

### Mechanical features

Weight	g	88
--------	---	----

### Ambient conditions

Temperature	Operating temperature			
		min	°C	-30
		max	°C	+50

### Dimensions

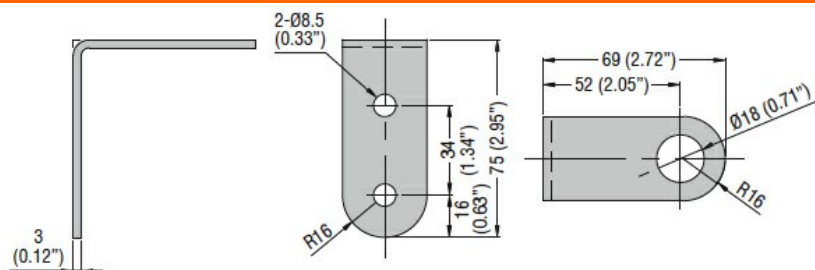

### Certifications and compliance

Compliance	IEC/EN/BS 60947-1
	IEC/EN/BS 60947-5-1

### ETIM classification

ETIM 8.0	EC001153 - Wall bracket for signal tower
----------	--