



Product designation

Signal tower
Ø50mm/1.97"

Product type designation

LTN50

General characteristics

Diameter	mm - inch	50 / 1.97
Material		Metal

Mechanical features

Weight	g	108
--------	---	-----

Ambient conditions

Temperature	Operating temperature			
		min	°C	-30
		max	°C	+50

Dimensions

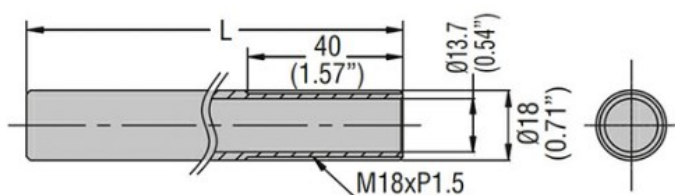

Type	L (mm/in)
LTP50P050T	50 (1.97")
LTP50P100T	100 (3.94")
LTP50P250T	250 (9.84")
LTP50P400T	400 (15.75")

Certifications and compliance

Compliance	CSA C22.2 n° 14
	IEC/EN/BS 60947-1
	IEC/EN/BS 60947-5-1
	UL508

Certificates

cULus

ETIM classification

ETIM 8.0	EC001155 - Tube for signal tower
----------	--