



Product designation			Safety switches with solenoid	
Product type designation			KEN1	
General characteristics				
General characteristics				
Housing Material			Polymer thermoplastic	
Contact characteristics				
Type of contact			1NO+1NC (Key), 2NC (Solenoid)	
Thermal current Ith			A	10
IEC/EN 60947-5-1 designation			A300 Q300	
Rated insulation voltage Ui			V	250
Rated impulse withstand voltage Uimp			kV	2.5
Short-circuit protection with fuse			Class/A	10 gG
IEC Conventional free air thermal current Ith			A	10
Operations				
Mechanical life			cycles	1000000
B10d			cycles	4000000
Mechanical operation			cycles/h	600
Output characteristics				
Mechanical life			cycles	1000000
Mechanical features				
Operating head fixing			Screwed	
Operating torque			N	15 (actuator insertion), 30 (Release actuator extraction), 1200 (locked actuator holding)
Tightening torque (Max)				
Switch fixing			Nm	2.5
Contact terminals			Nm	0.8
Body lid screw fixing			Nm	0.8
Conductor section				
IEC			min	mm ²
			max	mm ²
			1 or 2	
			1.5	
Cable connection			Self-releasing screw terminal	
Cable entry			3 x M20	
Weight			g	440

Ambient conditions

Pollution degree	3
Temperature	
Operating temperature	max °C +55
Storage temperature	min °C -40
	max °C +70

Dimensions

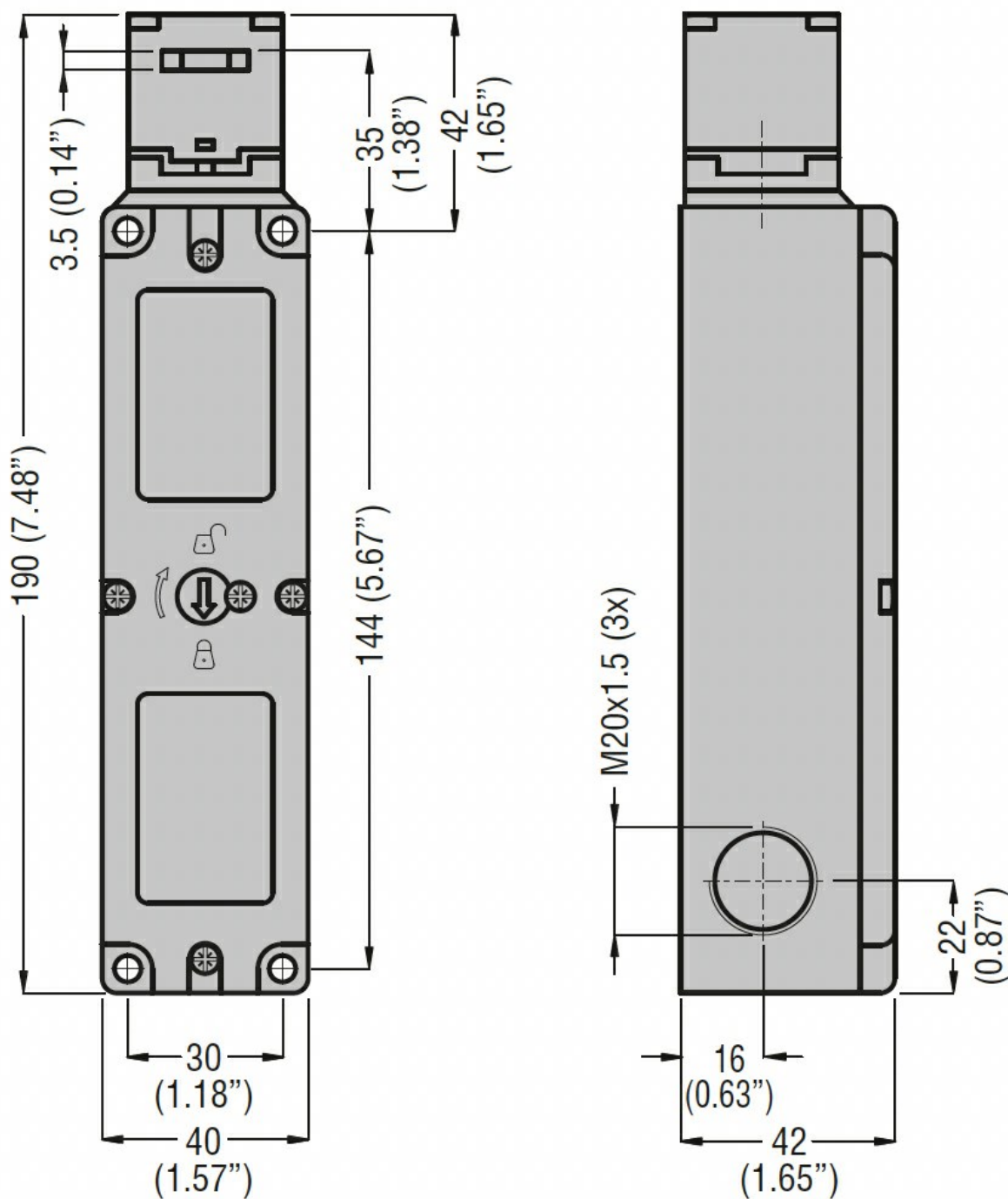

Wiring diagrams

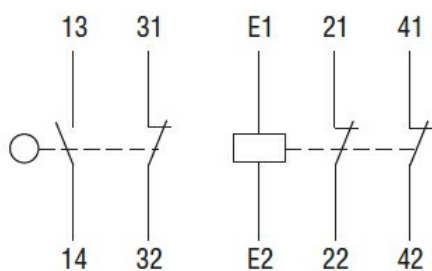

Certifications and compliance

Compliance

CSA C22.2 n°14
IEC/EN 60204
IEC/EN 60947-1
IEC/EN 60947-5-1
UL508
UNI EN ISO 14119

Certificates

cULus
EAC

ETIM classification

ETIM 8.0

EC000030 - End
switch