



Product designation

MODULAR  
CONTACTOR

Product type designation

CN

Operating voltage type

AC/DC

Number of poles

2

Number of DIN modules

1

### Electrical features

IEC Conventional free air thermal current I <sub>th</sub>	A	20
Operational current AC1 and AC-7a ≤400V	A	20
Operational current AC-3 and AC-7b ≤400V	A	9
Rated insulation voltage U <sub>i</sub> IEC/EN	V	440
Rated impulse withstand voltage U <sub>imp</sub>	kV	4
Minimum switching capacity		≥17V ≥50mA
Power dissipation per pole (average value) I <sub>th</sub>	W	1.7

### Control circuit

Auxiliary rated supply voltage U <sub>s</sub>		220VAC/VDC
Auxiliary contacts		
	NO	Nr. 1
	NC	Nr. 1
Average coil consumption ≤20°C		
	in-rush	W 2.5
	holding	W 2.5

Operating voltage

pick-up

min	%U <sub>s</sub>	85
max	%U <sub>s</sub>	110

drop-out

min	%U <sub>s</sub>	20
max	%U <sub>s</sub>	75

### Operating times

Average time

Closing NO

min	ms	15
max	ms	45

Opening NO

min	ms	25
max	ms	50

### Operations

Mechanical life	cycles	3000000
Electrical life AC-3	cycles	300000
Electrical life AC1	cycles	200000

### Ambient conditions

Operating temperature

min	°C	-15
max	°C	55

Storage temperature

min	°C	-40
max	°C	80
	m	2000

Max altitude

### Mechanical features

Fixing

DIN rail 35mm

Tightening torque for coil terminal

max	Nm	0.6
max	lbin	0.6

Tightening torque for terminals

max	Nm	1.2
max	lbin	0.9

Conductor section

Coil terminal

min	mm <sup>2</sup>	1
max	mm <sup>2</sup>	2.5

Power terminal

min	mm <sup>2</sup>	1
max	mm <sup>2</sup>	10

Terminals tool

PZ2

Weight

g 135

### Resistance & Protection

Frontal IP degree

IP20

Pollution degree

3

### Dimensions

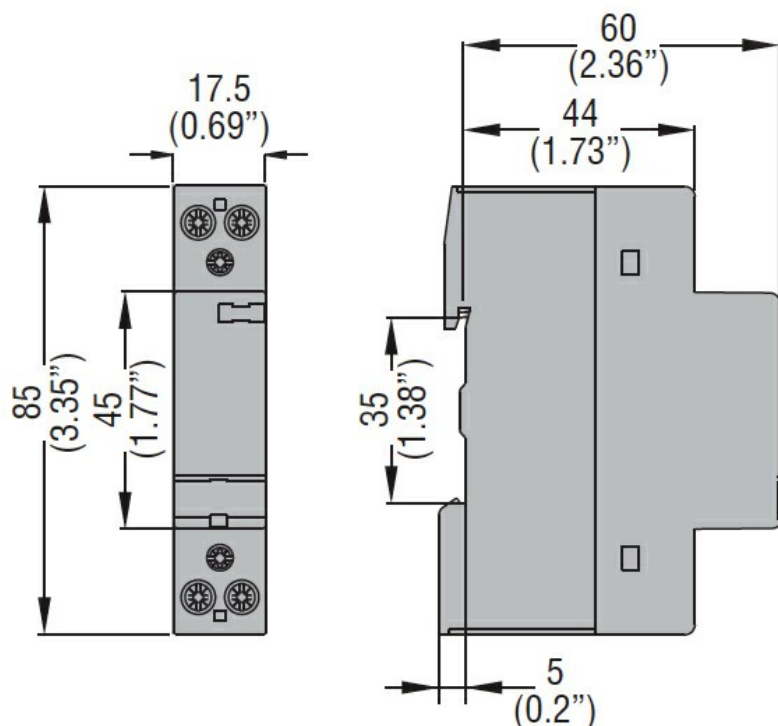

### Wiring diagrams

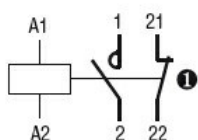

## Certifications and compliance

### Compliance

IEC/EN 60947-1  
IEC/EN 60947-4-1  
IEC/EN 60947-5-1  
IEC/EN 61095

### Certificates

EAC

## ETIM classification

ETIM 8.0

EC000066 -  
Power contactor,  
AC switching