

SURGE PROTECTION DEVICES



FOR PHOTOVOLTAIC
APPLICATIONS

 **Lovato**
electric

ENERGY AND AUTOMATION

SURGE PROTECTION DEVICES FOR PHOTOVOLTAIC APPLICATIONS

Type 1 and 2 with plug-in cartridge



SG2EDGK10M3R

Type 2 with plug-in cartridge



SG2DG600M2...



SGX02DG600M2

Order code	Pole arrangement	Relay output	Number of DIN modules	Qty per pkg	Wt
		(SPDT)	n°	n°	[kg]

VERSION WITH PLUG-IN CARTRIDGE.
EN short circuit current rating I_{scpv} 11kA.

SG2EDGK10M3R	+, -, PE	Yes	3	1	0.406
---------------------	----------	-----	---	---	-------

Order code	Pole arrangement	Relay output	Number of DIN modules	Qty per pkg	Wt
		(SPDT)	n°	n°	[kg]

VERSION WITH PLUG-IN CARTRIDGE.
EN short circuit current rating I_{scpv} 11kA.

SG2DG600M2	+, -, PE	No	2	1	0.320
SG2DG600M2R	+, -, PE	Yes	2	1	0.325
SG2DGK10M3	+, -, PE	No	3	1	0.396
SG2DGK10M3R	+, -, PE	Yes	3	1	0.406
SG2DGK50M3	+, -, PE	No	3	1	0.444

PLUG-IN CARTRIDGES

Order code	Description	Qty per pkg	Wt
		n°	[kg]
SGX02DG600M2	For SG2DG600M2/M2R type	1	0.320
SGX02DGK10M3	For SG2DGK10M3/M3R type	1	0.325
SGX02DGK50M3	For SG2DGK50M3 type	1	0.396

General characteristics

The surge protection device type SG2...with plug-in cartridge for photovoltaic applications is suitable for installation on the direct-current end of a photovoltaic installation and protects against induced overvoltage conditions.

The protection cartridges are plug-in and can be easily replaced for quick servicing.

Operational characteristics

- EN maximum continuous voltage U_{cpv}: 600VDC, 1100VDC, 1500VDC
- Versions with or without relay output having changeover contact for remote status indication
- EN degree of protection: IP20.

Characteristics

	Type	EN rated voltage	EN continuous voltage	EN voltage protection level
		U _n [VDC]	U _{cpv} [VDC]	U _p [kV]
SG2DG600M2	2	600	600	<1.9
SG2DG600M2R	2	600	600	<1.9
SG2DGK10M3	2	1100	1100	<3.8
SG2DGK10M3R	2	1100	1100	<3.8
SG2EDGK10M3R	1, 2	1100	1100	<3.8
SG2DGK50M3	2	1500	1500	<5.0

Certifications and compliance

Certification obtained: EAC.

Compliant with standards: IEC/EN 50539-11.

DIMENSIONS [mm]

SG2DG600M2

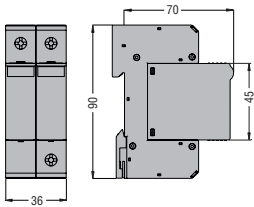

SG2DG600M2R

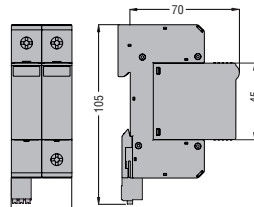

SG2DGK10M3 - SG2DGK50M3

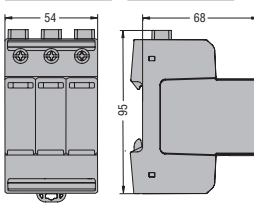

SG2DGK10M3R

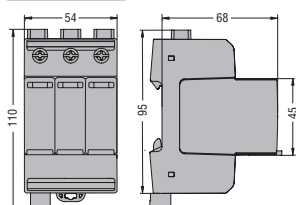

SG2EDGK10M3R

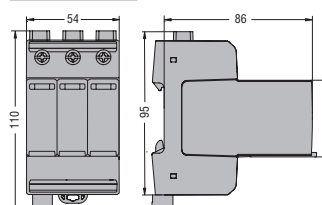

WIRING DIAGRAMS

SG2DG600M2

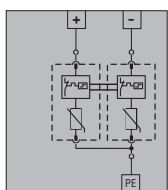

SG2DG600M2R

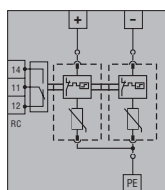

SG2DGK10M3
SG2DGK50M3

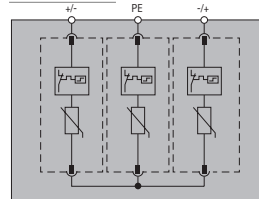

SG2DGK10M3R
SG2EDGK10M3R

