

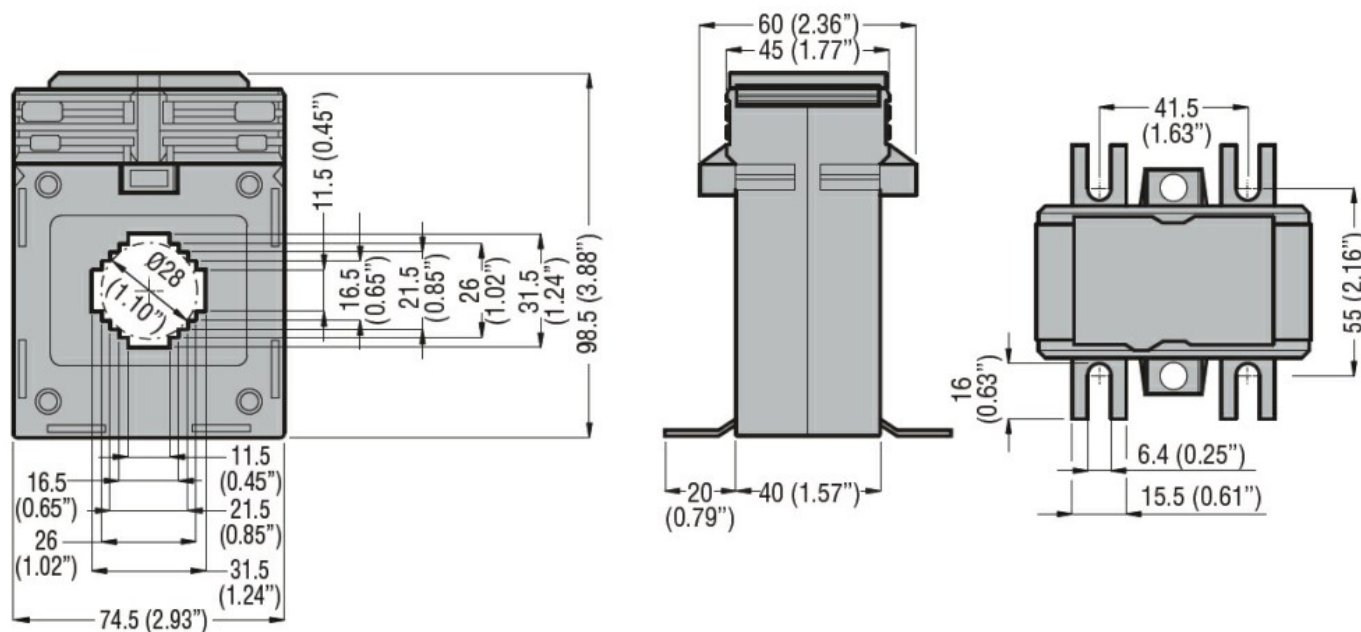

Product designation			Current transformers		
Product type designation			DM1TP0060		
Type of CT			Solid-core		
Current inputs					
Primary current I _{pn} (/5)			A	60	
Operational frequency			min	Hz	50
			max	Hz	60
Secondary output current			A	5	
Overload withstand I _{pn}			%	120	
Burden			cl. 0.5s	VA	1.5
			cl. 0.5	VA	1.5
Insulations					
Rated insulation voltage U _i IEC/EN			V	720	
IEC rated short-time thermal current I _{th}			I _{th} for s	40...60	
IEC rated dynamic current I _{dyn}			I _{th} for s	2.5	
Insulation dry type			Class E		
Mechanical features					
Terminals type			Screw		
Fixing			DIN rail or by Screw		
Weight			g	560	
Ambient conditions					
Temperature			Operating temperature		
			min	°C	-25
			max	°C	+50
Storage temperature			min	°C	-40
			max	°C	+80
Relative humidity			%	90	
Protection degree			IP30		
Dimensions					



Certifications and compliance

Certifications

IEC/EN/BS 61869-1

IEC/EN/BS 61869-2

Compliance

EAC

ETIM classification

EC000066 - Power contactor, AC switching

□