



| | | | | |
|---|--|--|--|------------------------------------|
| Product designation | | | | Switch disconnecter |
| Product type designation | | | | GD |
| Number of poles | | | | Nr. 2 |
| Operating voltage type | | | | DC |
| Contact characteristics | | | | |
| IEC Conventional free air thermal current I _{th} | | | | A 25 |
| Rated insulation voltage U _i IEC/EN | | | | V 1500 |
| Rated impulse withstand voltage U _{imp} | | | | kV 8 |
| Operating current I _e | | | | |
| DC21A | | | | |
| 600V | | | | A 25 |
| 800V | | | | A 25 |
| 1000V | | | | A 16 |
| DC21B | | | | |
| 600V | | | | A 25 |
| 800V | | | | A 25 |
| 1000V | | | | A 16 |
| DCPV1 | | | | |
| Operating current I _e 600V | | | | A 25 |
| Operating current I _e 800V | | | | A 25 |
| DCPV1 | | | | |
| 600V | | | | A 25 |
| 800V | | | | A 25 |
| Power dissipation per pole max | | | | W 0.8 |
| Rated short time current (1s) I _{cs} (rms) | | | | kA 0.5 |
| Mechanical life | | | | cycles 10000 |
| Mechanical features | | | | |
| Operating position | | | | normal allowable Vertical plan Any |
| Fixing | | | | Screw / DIN rail 35mm |
| Terminals | | | | |
| type | | | | Screw with washer |
| width | | | | mm 5.6 |
| height | | | | mm 6.5 |
| screw | | | | M4 |
| tool | | | | Phillips 1 |
| Tightening torque for terminals | | | | |
| min | | | | Nm 1.2 |
| max | | | | Nm 1.6 |
| min | | | | lbin 1.3 |
| max | | | | lbin 1.2 |
| Conductor section | | | | |

| | | |
|---------------|-----------------|----|
| IEC min | mm ² | 1 |
| IEC max | mm ² | 10 |
| AWG/kcmil min | | 18 |
| AWG/kcmil max | | 8 |

Ambient conditions

Operating temperature

| | | |
|-----|----|-----|
| min | °C | -25 |
| max | °C | +55 |

Storage temperature

| | | |
|-----|----|-----|
| min | °C | -40 |
| max | °C | +70 |

Max altitude

m 3000

Resistance & Protection

Frontal IP degree

IP20

Dimensions

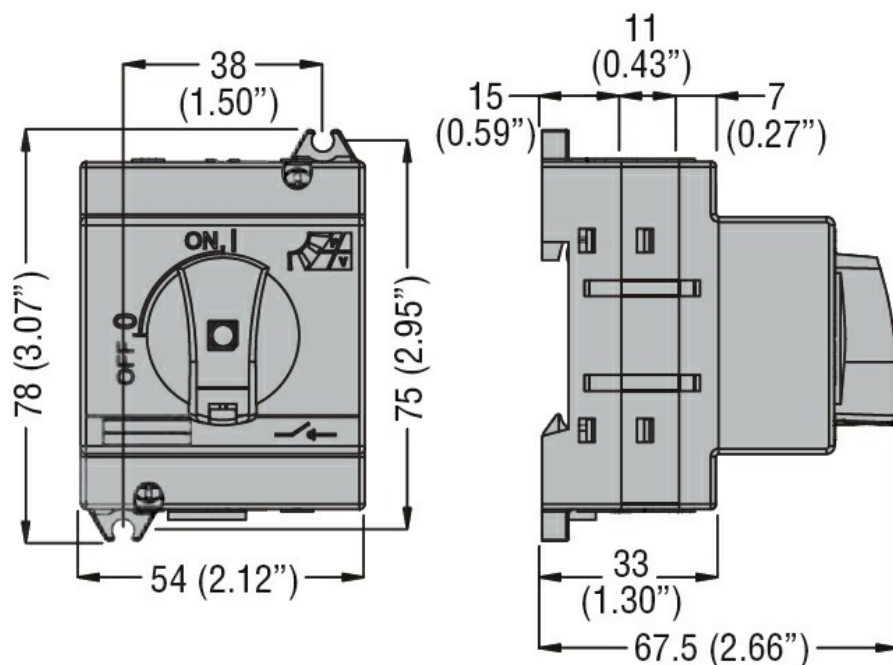

Wiring diagrams

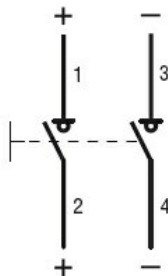

Certifications and compliance

Compliance

IEC/EN 60947-1
IEC/EN 60947-3

Certifications

EAC

ETIM classification

ETIM 8.0

EC000216 -
Switch
disconnector