

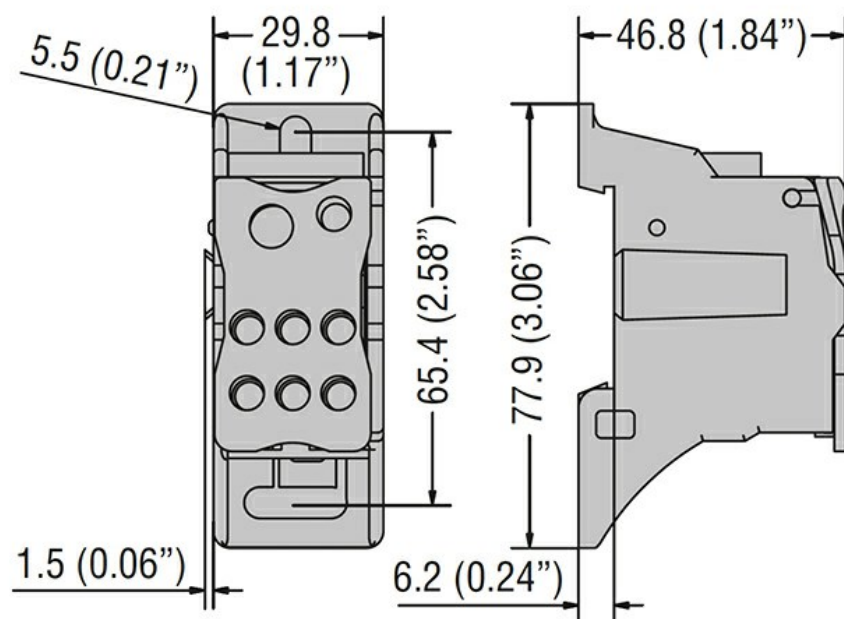

| | | |
|---|--------------------------|--------------------------|
| Product designation | Power distribution block | |
| Electrical features | | |
| Number of poles | | 1 |
| Rated insulation voltage Ui | V | 1000 |
| IEC Conventional free air thermal current Ith | A | 150 |
| Rated peak withstand current Ipk | kA | 30 |
| Rated short time current Icw 60s | A | 4.2 |
| Connections | | |
| Terminal hole diameter_Option 1 | mm | 1x10mm |
| Conductor section connectable_Option 1 | mm2 | 10...35 |
| Terminal hole diameter_Option 2 | mm | 1x7,5mm |
| Conductor section connectable_Option 2 | mm2 | 2,5...16 |
| Terminal hole diameter_Option 3 | mm | 6x6mm |
| Conductor section connectable_Option 3 | mm2 | 2,5...16 |
| Mechanical features | | |
| Operating position | normal allowable | Vertical plane Any |
| Fixing | | Screw / DIN rail 35mm |
| Metric Allen Key | mm | 3-6 |
| Weight | g | 154 |
| Resistance & Protection | | |
| Terminals IP degree | | IP20 front |
| Dimensions | | |



Certifications and compliance

Certifications

IEC/EN/BS 60947-7-1

Compliance

cURus

ETIM classification

EC000066 - Power contactor, AC switching

□