



Empty
enclosures
M2RA

Product designation

Product type designation

Electrical features

Maximum operating current ($\leq 440V$) A 32

Components

Contactor standard supplied BF25A, BF26A, BF32A

Thermal relay to purchase separately RF38

Mechanical features

Weight g 670

Ambient conditions

Operating temperature	min	°C	-25
	max	°C	+60

Storage temperature	min	°C	-40
	max	°C	+70

Resistance & Protection

Frontal IP degree IP65

Dimensions

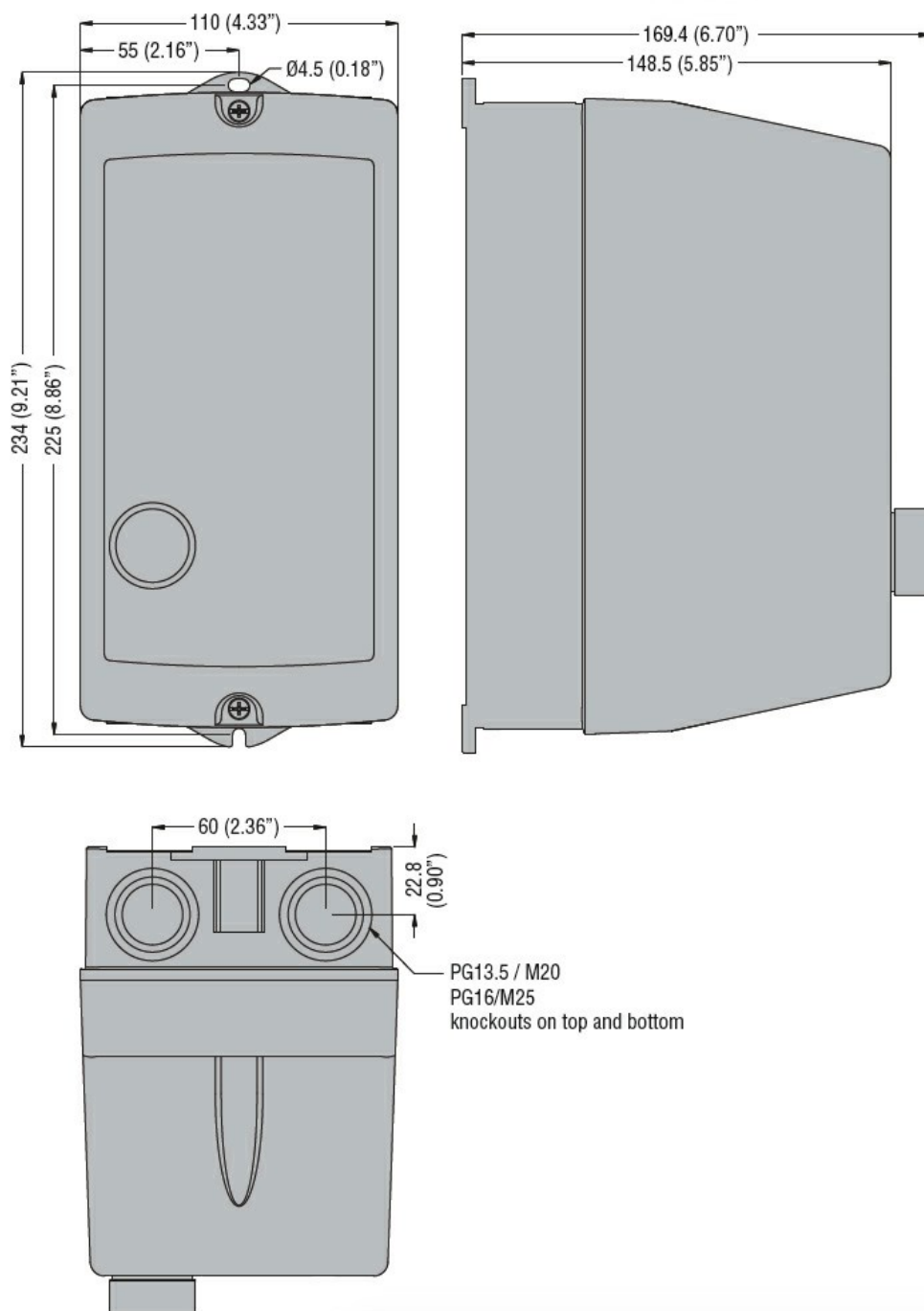

Wiring diagrams

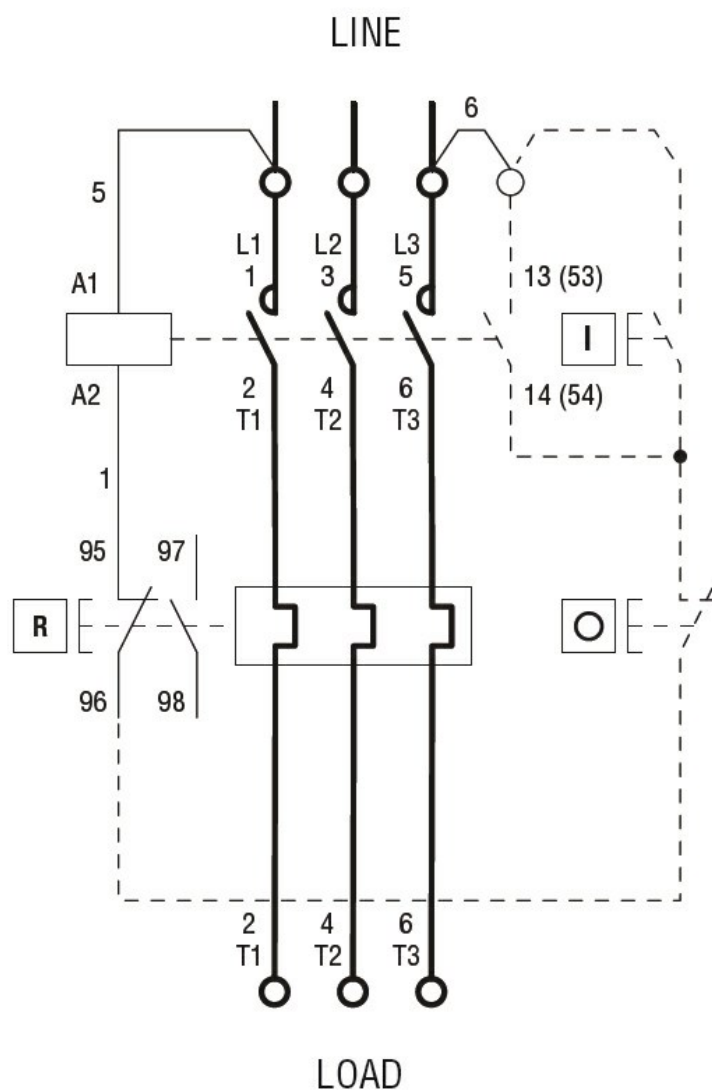

R = Reset; I = Start; O = Stop

Certifications and compliance

Compliance

CSA C22.2 n° 14
IEC/EN 60947-1
IEC/EN 60947-4-1
UL508

Certificates

cULus

ETIM classification

ETIM 8.0

EC000200 -
Enclosure for
control circuit
devices