



Product designation
Product type designation

Electrode holder
PS31

Connections

Terminals type

Screw

Ambient conditions

Temperature

Operating temperature

max °C +100

Housing

Weight

g 184

Dimensions

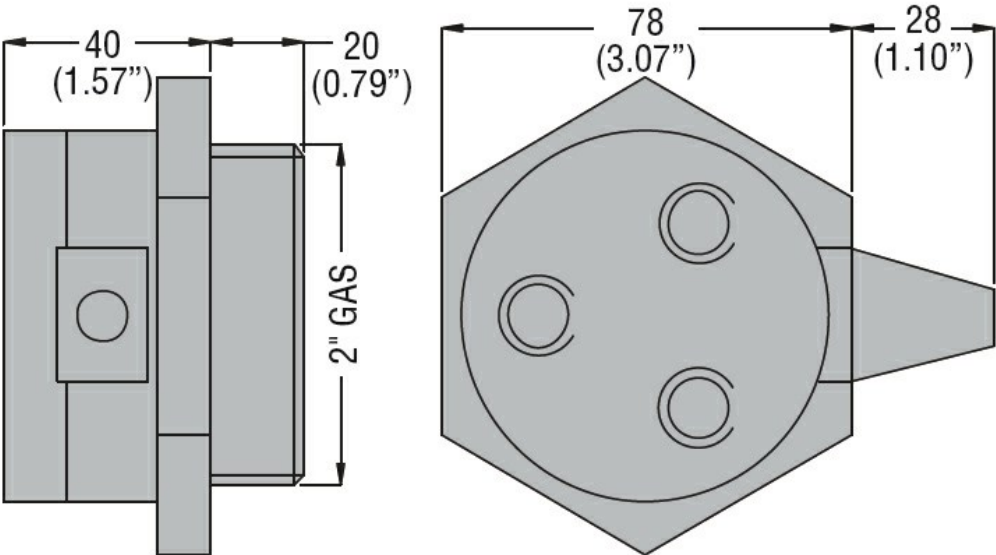

Certifications and compliance

Compliance

/

Certificates

EAC

ETIM classification

ETIM 8.0

EC010106 -
Liquid level
sensor